

Standard small model series product specifications

Standard: 2V, 4V, 6V, 8V, 10V, 12V

Rated capacity: 0.8Ah~28Ah(20Hr, 25°C)

Floating charge life: 10 years(25°C)

Battery Type	Voltage	Capacity	Internal Resistance	Dimensions-Millimeters (±2mm)				Terminal	Terminal	Approx Weight
	V	Ah(10HR)	(mΩ)	L	W	H	TH	Type	Position	Kg
FM4.5	2	4.5	6.2	46	25	100	106	F1	G	0.27
FM6.0	2	6.0	6.2	51	33	99	105	F1	G	0.34
FM15	2	15	3.5	70	47	101	107	F1	A	0.80
2FM2.0	4	2.0	28	45	33.5	75	81	F1	C	0.26
2FM3.0	4	3.0	20	66	33.5	75	81	F1	C	0.38
2FM3.2	4	3.2	15	90	34	60	66	F1	C	0.42
2FM4.0	4	3.3	25	32	32	135	146	F1	C	0.35
2FM4.5	4	4.5	18	48	48	102	108	F1	D	0.50
2FM4.5A	4	4.5	15	48	52	94	99	F1	C	0.55
2FM10	4	10	8.5	102	44	95	101	F2/F1	C	1.05
2FM20	4	20	4.5	149	43	154	165	F3	D	2.20
3FM1.0	6	1.0	60	51	42	51	57	F1	A	0.24
3FM1.2	6	1.2	52	97	24	52	58	F1	C	0.28
3FM2.3	6	2.0	25	43	37	76	76	Fab	L	0.34
3FM2.6	6	2.6	18	62	56	49	55	F1	A	0.40
3FM2.8	6	2.8	32	66	33	97	104	F1	A	0.48
3FM2.8A	6	2.8	32	66	33	100	106	F1	A	0.48
3FM3.2	6	3.2	28	134	35	61	67	F1	C	0.58
3FM3.2A	6	3.2	28	67	34	118	124	F1	A	0.61
3FM3.2B	6	3.2	28	125	33	61	67	F1	C	0.60
3FM3.5	6	3.5	18	194	25	50	56	F1	C	0.60
3FM4.0	6	4.0	30	70	47	101	107	F1	A	0.66
3FM4.5	6	4.5	25	70	47	101	107	F1	A	0.70
3FM5.0	6	5.0	15	70	47	101	107	F1	A	0.76
3FM6.0	6	6.0	12	70	47	101	107	F1	A	0.85
3FM6.5	6	6.5	17	151	34	94	100	F1/F2	C	1.05

Standard small model series product specifications

Battery Type	Voltage	Capacity	Internal Resistance	Dimensions-Millimeters (±2mm)				Terminal	Terminal	Approx Weight
	V	Ah(10HR)	(mΩ)	L	W	H	TH	Type	Position	Kg
3FM7.0	6	7.0	16	151	34	94	100	F1/F2	C	1.10
3FM7.2	6	7.2	16	151	34	94	100	F1/F2	C	1.15
3FM7.5	6	7.5	12	151	34	94	100	F1/F2	C	1.20
3FM8.5	6	8.5	9.5	151	34	94	100	F1/F2	C	1.28
3FM9.0	6	9.0	8.5	151	34	94	100	F1/F2	C	1.32
3FM10	6	10	14	151	50	94	100	F1/F2	C	1.58
3FM12	6	12	10	151	50	94	100	F1/F2	C	1.75
3FM20	6	20	8	157	83	125	130	F3	C	2.90
4FM3.2	8	3.2	30	68	49	91	91	Fab	L	0.85
4FM3.2A	8	3.2	28	134	36	63	69	F1	E	0.85
6FM0.8	12	0.8	200	96	25	62	62	plug	O	0.33
6FM1.2	12	1.2	90	97	43	52	58	F1	E	0.54
6FM1.4	12	1.4	70	97	43	52	58	F1	E	0.55
6FM1.2A	12	1.2	110	97	48	51	57	F1	F	0.56
6FM2.0	12	2.0	65	178	35	61	67	F1	C	0.78
6FM2.3	12	2.3	60	178	35	61	67	F1	C	0.82
6FM2.3C	12	2.0	130	182	24	61	61	Fab	M	0.68
6FM2.3CA	12	2.0	140	201	24	62	62	Fab	M	0.70
6FM2.0A	12	2.0	72	70	48	98	104	F1	C	0.68
6FM2.3A	12	2.3	60	70	48	98	104	F1	C	0.72
6FM2.6A	12	2.6	55	70	48	98	104	F1	C	0.78
6FM2.6	12	2.6	35	178	34	60	71	F1	F	0.90
6FM2.5	12	2.5	42	104	48	70	70	Fab	M	0.88
6FM2.7	12	2.7	38	104	48	70	70	Fab	M	0.95
6FM2.8	12	2.8	50	67	67	97	103	F1	C	0.98
6FM2.8A	12	2.8	50	132	33	98	104	F1	C	1.00
6FM2.9	12	2.9	42	79	56	99	105	F1	D	1.05
6FM3.2	12	3.2	52	134	67	61	67	F1	E	1.20
6FM3.4	12	3.4	50	134	67	61	67	F1	E	1.30
6FM4.2	12	4.2	45	195	47	70	76	F1	C	1.40

Standard small model series product specifications

Battery Type	Voltage	Capacity	Internal Resistance	Dimensions-Millimeters (±2mm)				Terminal	Terminal	Approx Weight
	V	Ah(10HR)	(mΩ)	L	W	H	TH	Type	Position	Kg
6FM4.5A	12	4.5	40	195	47	70	76	F1	C	1.50
6FM3.0	12	3.0	62	90	70	101	107	F1/F2	C	1.25
6FM3.5	12	3.5	60	90	70	101	107	F1/F2	C	1.32
6FM4.0	12	4.0	55	90	70	101	107	F1/F2	C	1.38
6FM4.5	12	4.5	45	90	70	101	107	F1/F2	C	1.44
6FM5.0	12	5.0	26	90	70	101	107	F1/F2	C	1.48
6FM6.0	12	6.0	22	90	70	101	107	F1/F2	C	1.60
6FM6.0A	12	6.0	24	151	52	94	99	F2/F1	F	1.90
6FM6.5S	12	6.5	24	151	51	95	100	F2/F1	F	1.85
6FM6.0	12	6.0	35	151	65	94	100	F1/F2	F	1.90
6FM6.5A	12	6.5	30	151	65	94	100	F1/F2	F	1.98
6FM7.0	12	7.0	28	151	65	94	100	F1/F2	F	2.02
6FM7.5	12	7.5	22	151	65	94	100	F1/F2	F	2.13
6FM8.5	12	8.5	20	151	65	94	100	F1/F2	F	2.40
6FM9.0	12	9.0	19	151	65	94	100	F1/F2	F	2.50
6FM10	12	10	24	151	98	95	101	F2/F1	F	3.00
6FM12	12	12	19	151	98	95	101	F2/F1	F	3.22
6FM13	12	13	11	151	98	95	101	F2/F1	F	3.40
6FM15	12	15	18	181	77	167	167	F3/T7	D	4.62
6FM17	12	17	17	181	77	167	167	F3/T7	D	4.96
6FM18	12	18	16	181	77	167	167	F3/T7	D	5.25
6FM20	12	20	12.5	181	77	167	167	F3/T7	D	5.65
6FM22	12	22	10	181	77	166	166	T7	D	6.30
6FM26	12	26	14	166	175	125	124	F3/T7	D	7.50
6FM28	12	28	10	166	175	125	124	F3 T7	D	8.60
6FM24A	12	24	14	165	125	175	182/175	F6/F7	D	7.60
6FM28A	12	28	11	165	125	175	182/175	F6/F7	D	8.10

Standard medium model series product specifications

Standard: 6V, 8V, 12V

Rated capacity: 33Ah~250Ah(10Hr, 25°C)

Floating charge life: 12 years(25°C)

Battery Type	Voltage	Capacity	Internal Resistance	Dimensions-Millimeters (±2mm)				Terminal	Terminal	Approx Weight
	V	Ah(10HR)	(mΩ)	L	W	H	TH	Type	Position	Kg
3FM36	6	36	4.5	162	88	164	170	F2	B	5.40
3FM42	6	42	4.2	162	88	164	170	F2	B	6.00
3FM45	6	45	4	162	88	164	170	F2	B	6.30
3FM100	6	100	3.2	194	170	205	210	T9	A	15.5
3FM150	6	150	2.7	260	180	245	250	T10	B	23.5
3FM180A	6	180	2.4	260	180	245	250	T10	B	28.0
3FM180	6	180	2.3	307	169	220	225	T10	B	27.5
3FM190	6	190	2.5	243	187	253	276	T10	B	28.5
3FM200	6	200	2	321	176	226	246/229	F5/T11	A	30.5
3FM300	6	300	1.8	295	178	345	348	T10	B	45.0
4FM180	8	180	3	260	182	295	298	T10	C	36.5
6FM33	12	33	11	195	130	155	180/166	F7/T9	C	9.70
6FM35	12	35	10.5	195	130	155	180/166	F7/T9	C	10.2
6FM34	12	34	12	310	77	166	172/180	F2/F3	D	9.50
6FM38	12	38	9.5	197	165	170	170	F4/T9	D	12.0
6FM40	12	40	9	197	165	170	170	F4/T9	D	12.5
6FM45	12	45	8.8	197	165	170	170	F4/T9	D	13.5
6FM50	12	50	7.5	229	138	208	230/211	F5/T9	C	16.2
6FM55	12	55	6.5	229	138	208	230/211	F5/T9	C	16.9
6FM64	12	64	6.5	260	168	211	233/214	F5/T9	C	21.3
6FM75	12	75	6	260	168	211	233/214	F5/T9	C	22.5

Standard medium model series product specifications

Battery Type	Voltage	Capacity	Internal Resistance	Dimensions-Millimeters (±2mm)				Terminal	Terminal	Approx Weight
	V	Ah(10HR)	(mΩ)	L	W	H	TH	Type	Position	Kg
6FM80A	12	80	5.5	260	168	211	233/214	F5/T9	C	23.5
6FM85	12	85	5	260	168	211	233/214	F5/T9	C	24.5
6FM65	12	65	6	350	167	179	186/179	F5/T9	C	20.2
6FM70A	12	70	5.5	350	167	179	186/179	F5/T9	C	21.5
6FM75A	12	75	5.4	350	167	179	186/179	F5/T9	C	22.2
6FM78	12	78	5	350	167	179	186/179	F5/T9	C	23.0
6FM80	12	80	4	350	167	179	186/179	F5/T9	C	23.5
6FM90	12	90	5.5	306	169	211	233/211	F5/T9	C	27.0
6FM95	12	95	5	306	169	211	233/211	F5/T9	C	27.5
6FM100A	12	100	4	306	169	211	233/211	F5/T9	C	30.0
6FM90A	12	90	5	327	171	211	224/215	F5/T9	C	27.0
6FM100	12	100	4.5	327	171	211	224/215	F5/T9	C	28.6
6FM100B	12	100	4.5	406	173	208	238	F8/T10	C	31.8
6FM120	12	120	4	406	173	208	238	F8/T10	C	34.7
6FM100B	12	100	4.5	409	176	225	225	F5/T10	C	31.0
6FM120A	12	120	4	409	176	225	225	F5/T10	C	34.1
6FM110	12	110	4	281	267	207	210	T10	B	33.0
6FM134	12	134	3.8	342	172	280	285	T10	C	38.5
6FM150	12	150	3.5	485	172	240	242/240	F5/T10	C	41.6
6FM200	12	200	3	522	238	218	238/221	F5/T10	E	58.5
6FM230	12	230	2.9	521	269	203	223/206	F5/T10	E	65.3
6FM250	12	250	2.7	521	269	220	242/223	F5/T10	E	69.5

GFM series product specification sheet

Standard: 2V

Rated capacity: 50Ah~3000Ah(10Hr, 25°C)

Floating charge life: 20 years(25°C)

Battery Type	Voltage	Capacity	Internal Resistance	Dimensions-Millimeters (±2mm)				Terminal	Terminal	Approx Weight
	V	Ah(10HR)	(mΩ)	L	W	H	TH	Type	Position	Kg
GFM2-50	2	50	1.1	161	50	166	175	T4	B	3.1
GFM2-100	2	100	0.88	171	72	205	210	T9	G	5.45
GFM2-150	2	150	0.65	171	102	206	221	T11	G	8.3
GFM2-200	2	200	0.89	173	109	330	364	T11	G	12.5
GFM2-250	2	250	0.82	173	109	330	364	T11	G	14.8
GFM2-300	2	300	0.76	171	151	330	364	T11	G	18.0
GFM2-350	2	350	0.71	171	151	330	364	T11	G	20.5
GFM2-400	2	400	0.62	210	171	330	367	T11	H	25.5
GFM2-500	2	500	0.52	241	171	330	365	T11	H	31.5
GFM2-600	2	600	0.45	302	175	330	367	T11	H	36.5
GFM2-800	2	800	0.35	410	175	330	367	T11	J	50.5
GFM2-1000	2	1000	0.28	475	175	330	367	T11	J	60.5
GFM2-1500	2	1500	0.23	400	350	345	382	T11	K	93.5
GFM2-2000	2	2000	0.21	490	350	345	382	T11	L	124
GFM2-3000	2	3000	0.16	710	350	345	382	T11	L	190

Front terminal series product specifications

Standard: 12V

Rated capacity: 50Ah~180Ah(10Hr, 25°C)

Floating charge life: 15 years(25°C)

Battery Type	Voltage	Capacity	Internal Resistance	Dimensions-Millimeters (±2mm)				Terminal	Terminal	Approx Weight
	V	Ah(10HR)	(mΩ)	L	W	H	TH	Type	Position	Kg
6FM50FT	12	50	7.8	277	106	221	221	T8	E	14.8
6FM55FT	12	55	6.6	277	106	221	221	T8	E	15.5
6FM100FT	12	100	5.5	506	110	224	239	T9	E	30.0
6FM105FT	12	105	5.5	395	110	286	286	T10	E	31.0
6FM110FT	12	110	5	395	110	286	286	T10	E	32.0
6FM110AFT	12	110	4.5	560	125	228	228	T10	E	32.5
6FM120FT	12	120	4.6	551	110	239	239	T10	E	34.5
6FM150FT	12	150	4.3	551	110	287	287	T10	E	45.0
6FM180FT	12	180	3.8	546	125	317	323	T10	E	54.0

Long-life series product specifications

Standard: 12V

Rated capacity: 7.0Ah~250Ah(10Hr, 25°C)

Floating charge life: 15 years(25°C)

Battery Type	Voltage	Capacity	Internal Resistance	Dimensions-Millimeters (±2mm)				Terminal	Terminal	Approx Weight
	V	Ah(10HR)	(mΩ)	L	W	H	TH	Type	Position	Kg
6FM7.0L	12	7.0	28.0	151	65	94	100	F1/F2	F	2.30
6FM12L	12	12.0	19	151	98	95	101	F2/F1	F	3.90
6FM18L	12	18.0	16	181	77	167	167	F3/T7	D	5.60
6FM24L	12	24.0	14	166	175	125	125	F3/T7	D	7.90
6FM28L	12	28.0	10	166	175	125	125	F3/T7	D	8.80
6FM33L	12	33	10	195	130	155	180/166	F7/T8	C	10.5
6FM40L	12	40	8.5	197	165	170	170	F4/T8	D	13.0
6FM50L	12	50	7.5	229	138	208	230/211	F5/T8	C	16.2
6FM55L	12	55	6.5	229	138	208	230/211	F5/T8	C	17.0
6FM65L	12	65	6	350	167	179	186/179	F5/T8	C	22.5
6FM60L	12	60	7	260	168	211	233/214	F5/T8	C	21.0
6FM70L	12	60	6.5	260	168	211	233/214	F5/T8	C	23.5
6FM90L	12	90	5.5	306	169	211	233/214	F5/T9	C	27.5
6FM100L	12	100	4.5	330	171	214	224/220	F5/T9	C	30.0
6FM120L	12	120	4	409	176	225	225	F5/T10	C	35.5
6FM150L	12	150	3.5	485	172	240	242/240	F5/T10	C	45.0
6FM200L	12	200	3	522	238	218	238/221	F5/T10	E	62.0
6FM250L	12	250	2.6	521	269	220	242/223	F5/T10	E	74.0
6FM50FT	12	50	7.8	277	106	221	221	T8	E	14.8
6FM55FT	12	55	6.6	277	106	221	221	T8	E	15.5
6FM100FT	12	100	5.5	506	110	224	239	T9	E	30.0
6FM105FT	12	105	5.5	395	110	286	286	T10	E	31.0
6FM110FT	12	110	5	395	110	286	286	T10	E	32.0
6FM110AFT	12	110	4.5	560	125	228	228	T10	E	32.5
6FM120FT	12	120	4.6	551	110	239	239	T10	E	34.5
6FM150FT	12	150	4.3	551	110	287	287	T10	E	45.0
6FM180FT	12	180	3.8	546	125	317	323	T10	E	54.0

Deep cycle series product specifications

Standard: 6V, 12V

Rated capacity: 5Ah~250Ah

Battery Type	Voltage	Capacity	Internal Resistance	Dimensions-Millimeters (±2mm)				Terminal	Terminal	Approx Weight
	V	Ah(10HR)	(mΩ)	L	W	H	TH	Type	Position	Kg
6FM5.0D	12	5	26	90	70	101	107	F1/F2	C	1.55
6FM7.0D	12	8	28	151	65	94	100	F1/F2	F	2.20
6FM9.0D	12	9	19	151	65	94	100	F1/F2	F	2.55
6FM12D	12	12	19	151	98	95	101	F2/F1	F	3.45
6FM18D	12	18	16	181	77	167	167	F3/T7	D	5.30
6FM20D	12	20	12	181	77	167	167	F3/T7	D	5.60
6FM24D	12	24	14	166	175	125	125	F3/T7	D	7.60
6FM28D	12	28	10	166	175	125	125	F3/T7	D	8.65
3FM100D	6	100	3	194	170	205	210	T9	A	15.8
3FM150D	6	150	2.5	260	180	245	250	T10	B	23.8
3FM190D	6	190	2.2	243	187	253	276	T10	B	29.5
3FM200D	6	200	2	321	176	226	246/229	F5/T10	A	30.5
3FM300D	6	300	1.5	295	178	345	348	T10	B	47.0
6FM33D	12	33	10	195	130	155	180/166	F7/T8	C	9.50
6FM40D	12	40	8.5	197	165	170	170	T8	D	12.8
6FM55D	12	55	6.5	229	138	208	230/211	F5/T8	C	16.5
6FM60D	12	60	7	260	168	211	233/214	F5/T8	C	18.5
6FM70D	12	70	6.5	260	168	211	233/214	F5/T8	C	21.5
6FM65D	12	65	6	350	167	179	186/179	F5/T9	C	20.5
6FM90D	12	90	5.5	306	169	211	233/214	F5/T9	C	27.5
6FM100D	12	100	4.5	330	171	214	224/220	F5/T9	C	29.5
6FM120D	12	120	4	409	176	225	225	F5/T10	C	35.0
6FM150D	12	150	3.5	485	172	240	242/240	F5/T10	C	43.0
6FM200D	12	200	3	522	238	218	238/221	F5/T10	E	60.0
6FM250D	12	250	2.6	521	269	220	242/223	F5/T10	E	72.5

High temperature series product specifications

Standard: 6V, 12V

Rated capacity: 7Ah~250Ah

Battery Type	Voltage	Capacity	Internal Resistance	Dimensions-Millimeters (±2mm)				Terminal	Terminal	Approx Weight
	V	Ah(10HR)	(mΩ)	L	W	H	TH	Type	Position	Kg
6FM7.0T	12	7	28	151	65	94	100	F1/F2	F	2.10
6FM12T	12	12	19	151	98	95	101	F2/F1	F	3.45
6FM18T	12	18	16	181	77	167	167	T3/T8	D	5.60
6FM24T	12	24	14	166	175	125	125	T3/T8	D	7.90
3FM200T	6	200	2	321	176	226	246/229	5/F10	A	31.0
6FM33T	12	33	10	195	130	155	180/166	T7/T8	C	10.0
6FM40T	12	40	8.5	197	165	170	170	T4/T8	D	13.0
6FM65T	12	65	6	350	167	179	186/179	F5/T8	C	22.5
6FM60T	12	60	7	260	168	211	233/214	F5/T8	C	21.0
6FM70T	12	60	6.5	260	168	211	233/214	F5/T8	C	23.7
6FM90T	12	90	5.5	306	169	211	233/214	F5/T9	C	27.5
6FM100T	12	100	4.5	330	171	214	224/220	F5/T9	C	30.0
6FM120T	12	120	4	409	176	225	225	5/F10	C	35.5
6FM150T	12	150	3.5	485	172	240	242/240	5/F10	C	45.0
6FM200T	12	200	3	522	238	218	238/221	5/F10	E	62.0
6FM250T	12	250	2.6	521	269	220	242/223	5/F10	E	74.0

High-power series product specifications

Standard: 6V, 12V

Rated capacity: 5Ah~250Ah

Battery Type	Voltage	Capacity	Internal Resistance	Dimensions-Millimeters (±2mm)				Terminal	Terminal	Approx Weight	
	V	Ah(10HR)	(mΩ)	L	W	H	TH	Type	Position		
3FM4.5HR	6	19	4.5	15	70	47	101	107	F1/F2	A	0.72
3FM5.0HR	6	22	5.0	12	70	47	101	107	F1/F2	A	0.85
3FM7.0HR	6	31	7.0	9	151	34	94	100	F1/F2	C	1.15
3FM9.0HR	6	34	9.0	8	151	34	94	100	F1/F2	C	1.35
3FM12HR	6	50	12.0	6	151	50	94	100	F1/F2	E	1.82
6FM4.5HR	12	19	4.5	26	90	70	101	107	F1/F2	C	1.60
6FM5.0HR	12	22	5.0	22	90	70	101	107	F1/F2	C	1.65
6FM6.0HR	12	24	6.0	18	151	52	94	99	F2/F1	E	1.90
6FM7.0HR	12	32	7.0	20	151	65	94	100	F1/F2	E	2.35
6FM9.0HR	12	34	9.0	18	151	65	94	100	F1/F2	E	2.60
6FM12HR	12	50	12.0	11	151	98	95	101	F2/F1	E	3.90
6FM18HR	12	76	18.0	12	181	77	167	167	F3/T8	D	5.60
6FM20HR	12	82	20.0	10	181	77	166	166	T8	D	6.30
6FM24HR	12	100	24.0	10	166	175	125	125	F3/T8	D	8.20
6FM28AHR	12	110	28.0	9	165	125	175	182/175	T8	D	9.10
6FM33HR	12	125	33	9	195	130	155	180/166	F7/T8	D	10.5
6FM45HR	12	160	45	7.5	197	165	170	170	F4/T8	D	14.0
6FM65HR	12	240	65	5.5	350	167	179	186/179	F5/T8	D	21.5
6FM70HR	12	250	70	6	260	168	211	233/214	F5/T9	D	23.0
6FM75HR	12	270	75	5.5	260	168	211	233/214	F5/T9	D	23.5
6FM90HR	12	320	90	4.5	306	169	211	233/214	F5/T9	D	29.5
6FM100HR	12	380	100	3.5	330	171	214	224/220	F5/T9	D	31.5
6FM120HR	12	425	120	3.2	409	176	225	225	F5/T10	D	36.5
6FM134HR	12	475	134	3.5	342	172	280	285	T10	D	43.0
6FM140HR	12	500	140	3.2	342	172	280	285	T10	D	46.0
6FM150HR	12	530	150	3	485	172	240	242/240	F5/T10	D	47.0
6FM200HR	12	705	200	2.8	522	238	218	238/221	F5/T10	E	65.0

GEL series product specifications

Standard: 2V, 6V, 12V

Rated capacity: 50Ah~3000Ah(10Hr, 25°C)

Floating charge life: 20 years(25°C)

Battery Type	Voltage	Capacity	Internal Resistance	Dimensions-Millimeters (±2mm)				Terminal	Terminal	Approx Weight
	V	Ah(10HR)	(mΩ)	L	W	H	TH	Type	Position	
3FM100G	6	100	3.3	194	170	205	210	T9	A	15.8
3FM200G	6	200	2.2	321	176	226	246/229	T5/T11	A	31.0
6FM33G	12	33	11.0	195	130	155	180/166	T7/T9	C	9.60
6FM40G	12	40	9.5	197	165	170	170	T4/T9	D	12.5
6FM55G	12	55	7.0	229	138	208	230/211	T5/T9	C	16.5
6FM65G	12	65	6.6	350	167	179	186/179	T5/T9	C	21.0
6FM60G	12	60	7.7	260	168	211	233/214	T5/T9	C	19.0
6FM70G	12	70	7.0	260	168	211	233/214	T5/T9	C	21.5
6FM100G	12	100	5.0	330	171	214	224/220	F5/T9	C	28.6
6FM120G	12	120	4.4	409	176	225	225	F5/T10	C	34.5
6FM134G	12	134	4.2	342	172	280	285	T10	C	42.0
6FM150G	12	150	3.9	485	172	240	242/240	F5/T10	C	46.0
6FM200G	12	200	3.3	522	238	218	238/221	F5/T10	E	58.5
6FM250G	12	250	2.9	521	269	220	242/223	F5/T10	E	69.5
GFM2-100G	2	100	0.90	171	72	206	209	T9	A	5.50
GFM2-150G	2	150	0.70	171	102	206	221	T11	A	8.30
GFM2-200G	2	200	0.95	173	109	330	364	T11	G	13.5
GFM2-300G	2	300	0.80	171	151	330	364	T11	G	18.0
GFM2-400G	2	400	0.65	210	176	330	367	T11	H	26.5
GFM2-500G	2	500	0.55	241	171	330	365	T11	H	31.5
GFM2-600G	2	600	0.50	302	175	330	367	T11	H	38.0
GFM2-800G	2	800	0.40	410	175	330	367	T11	J	53.5
GFM2-1000G	2	1000	0.30	475	175	330	367	T11	J	64.0
GFM2-1500G	2	1500	0.22	400	350	345	382	T11	K	97.0
GFM2-2000G	2	2000	0.20	490	350	345	382	T11	L	130
GFM2-3000G	2	3000	0.13	710	350	345	382	T11	L	198

OPzV series product specifications

Standard: 2V

Rated capacity: 100Ah~3000Ah(10Hr, 25°C)

Floating charge life: 20 years(25°C)

Battery Type	Voltage	Capacity	Internal Resistance	Dimensions-Millimeters (±2mm)				Terminal	Terminal	Approx Weight
	V	Ah(10HR)	(mΩ)	L	W	H	TH	Type	Position	Kg
OPzV100	2	100	1.20	103	206	355	390	T12	G	12.0
OPzV200	2	200	1.00	103	206	355	390	T12	G	16.2
OPzV250	2	250	0.95	124	206	355	390	T12	G	21.2
OPzV300	2	300	0.85	145	206	355	390	T12	G	23.5
OPzV350	2	350	0.80	124	206	471	506	T12	G	26.5
OPzV420	2	420	0.70	145	206	471	506	T12	G	30.5
OPzV500	2	500	0.65	166	206	471	506	T12	G	35.0
OPzV600	2	600	0.55	145	206	646	681	T12	G	41.0
OPzV770	2	770	0.50	253	210	472	507	T12	G	56.0
OPzV800	2	800	0.45	191	210	646	681	T12	H	57.5
OPzV1000	2	1000	0.35	233	210	646	681	T12	H	68.5
OPzV1200	2	1200	0.30	275	210	646	681	T12	H	82.0
OPzV1500	2	1500	0.25	275	210	796	831	T12	H	101
OPzV2000	2	2000	0.20	399	210	772	807	T12	I	135
OPzV2500	2	2500	0.18	487	212	772	807	T12	J	172
OPzV3000	2	3000	0.15	576	212	772	807	T12	J	205

OPzS series product specifications

Standard: 2V

Rated capacity: 100Ah~3000Ah(10Hr, 25°C)

Floating charge life: 20 years(25°C)

Battery Type	Voltage	Capacity	Internal Resistance	Dimensions-Millimeters (±2mm)				Terminal	Terminal	Approx Weight ± 5%(Kg)		
	V	Ah(10HR)	(mΩ)	L	W	H	TH	Type	Position	Dry weight	Wet weight	Acid weight (d1.24)
OPzS100	2	100	1.15	103	206	355	410	T12	G	8.5	13.5	5.00
OPzS150	2	150	0.95	103	206	355	410	T12	G	11	15.5	4.50
OPzS200	2	200	0.85	103	206	355	410	T12	G	13.5	17.5	4.00
OPzS250	2	250	0.75	124	206	355	410	T12	G	16	21	5.00
OPzS300	2	300	0.65	145	206	355	410	T12	G	18.5	24.5	6.00
OPzS350	2	350	0.62	124	206	471	526	T12	G	21	27.5	6.50
OPzS420	2	420	0.55	145	206	471	526	T12	G	24.5	33	8.50
OPzS500	2	500	0.5	166	206	471	526	T12	G	28	35.5	7.50
OPzS600	2	600	0.45	145	206	646	701	T12	G	34	43.5	9.50
OPzS770	2	770	0.35	253	210	472	527	T12	G	42.5	56.5	14.0
OPzS800	2	800	0.3	191	210	646	701	T12	H	44	58	14.0
OPzS1000	2	1000	0.26	233	210	646	701	T12	H	52	71	19.0
OPzS1200	2	1200	0.22	275	210	646	701	T12	H	62	85	23.0
OPzS1500	2	1500	0.21	275	210	796	851	T12	H	75	105	30.0
OPzS2000	2	2000	0.16	399	210	772	827	T12	I	108	150	42.0
OPzS2500	2	2500	0.12	487	212	772	827	T12	J	130	183	53.0
OPzS3000	2	3000	0.11	576	212	772	827	T12	J	157	220	63.0

端子规格

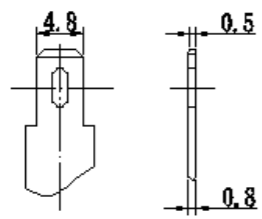

F1 (0.187)

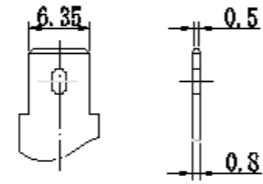

F2 (0.250)

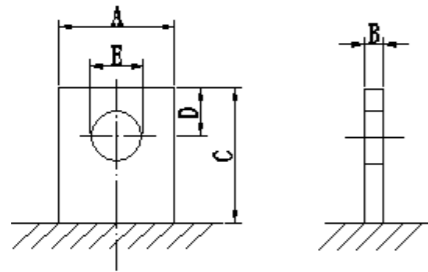

类型	A	B	C	D	B	材料
F3	12	2.0	14	5.0	φ5.5	Cu
F4	20	3.0	16	7.0	φ6.0	Cu
F5	22	3.5	22	8.5	φ8.0	Cu
F6	25	3.0	22	9.5	φ9.0	Cu
F7	17	6.0	16	7.0	φ8.0	Pb
F8	25	7.0	24	10.5	φ9.0	Pb

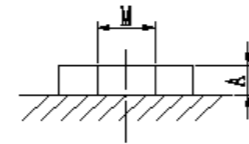

类型	M	φ	A
T7	5	12	3
T8	6	14	3
T9	6	16	3
T10	8	16	3
T11	8	20	5
T12	8	20	7

端子位置



A*



B



C

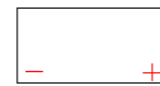

D*



E*



F



G



H



I

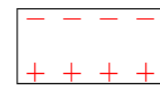

J

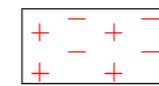

K

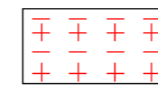

L

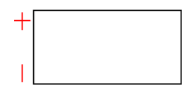

M

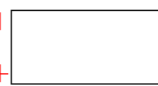

N*

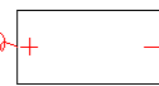

O

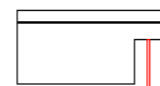

P

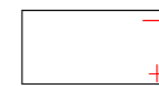

Q

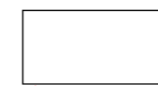

R